

Linking module with legs (right or left)

BJ-EMAEND-P , BJ-EMAENI-P

Linking modules for the joint of the large modules with the small ones

One of our modular furniture options, designed for lying down, sitting down, giving a massage, watching, chatting, feeling...

An easily expandable modular system that you can use to create fantastic combinations. The modules are designed in bright colors to create pleasant designs and combinations. Designed to provide **great comfort** for the user and **complete safety** for the professionals.

The modules with feet can be used with people who require floor hoists for mobility.

Measures:

- Height: 110 x 70 x 40 cm
- Low: 110 x 70 x 24 cm
- With legs: 110 x 70 x 40 cm. Height of module 24 cm, height of legs 26 cm

Materials

- The vinyl materials we use in our products are designed to meet the strictest market requirements.
- Antimicrobial, antibacterial and antifungal protection.
- Abrasion resistant.
- Resistant to human sweat and saliva, urine and blood.
- Total weight: 620 gr/m²
- Thickness: 0.5mm - 1 mm
- Complies with REACH regulation
- Fire-resistant: M2 classification
- Complies with EN71-3 toy safety.
- Highly resistant to the sun.

Foams

All the foam we use in our products, both polyurethane and

polyethylene, are standardized and comply with the strictest European technical and environmental regulations.

Colors

Gray, black, blue, light blue, red, orange, yellow, pistachio, green, cream, white, brown.

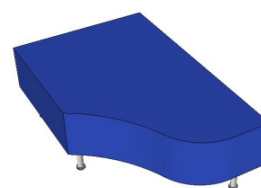
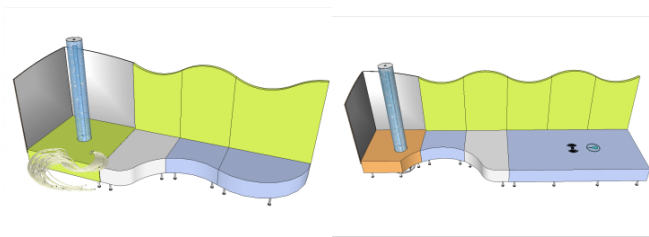
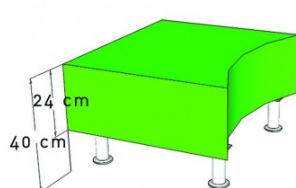

BJ-EMAENI-P
(LEFT)



BJ-EMAEND-P
(RIGHT)

